

geratech[®]



EGE-AUD-2-HDAUD

HDMI Audio Inserter

DISCLAIMERS

The information in this manual has been carefully checked and is believed to be accurate. Geratech assumes no responsibility for any infringements of patents or other rights of third parties which may result from its use.

Geratech assumes no responsibility for any inaccuracies that may be contained in this document. Geratech also makes no commitment to update or to keep current the information contained in this document.

Geratech reserves the right to make improvements to this document and/or product at any time and without notice.

COPYRIGHT NOTICE

No part of this document may be reproduced, transmitted, transcribed, stored in a retrieval system, or any of its part translated into any language or computer file, in any form or by any means—electronic, mechanical, magnetic, optical, chemical, manual, or otherwise—without express written permission and consent from Geratech.

© Copyright 2011 by Geratech.

All Rights Reserved.

Version 1.0 September 2011

TRADEMARK ACKNOWLEDGMENTS

All products or service names mentioned in this document may be trademarks of the companies with which they are associated.

SAFETY PRECAUTIONS

Please read all instructions before attempting to unpack, install or operate this equipment and before connecting the power supply.

Please keep the following in mind as you unpack and install this equipment:

- Always follow basic safety precautions to reduce the risk of fire, electrical shock and injury to persons.
- To prevent fire or shock hazard, do not expose the unit to rain, moisture or install this product near water.
- Never spill liquid of any kind on or into this product.
- Never push an object of any kind into this product through any openings or empty slots in the unit, as you may damage parts inside the unit.
- Do not attach the power supply cabling to building surfaces.
- Use only the supplied power supply unit (PSU). Do not use the PSU if it is damaged.
- Do not allow anything to rest on the power cabling or allow any weight to be placed upon it or any person walk on it.
- To protect the unit from overheating, do not block any vents or openings in the unit housing that provide ventilation and allow for sufficient space for air to circulate around the unit.

REVISION HISTORY

VERSION NO.	DATE DD/MM/YY	SUMMARY OF CHANGE
VR0	25/07/13	Preliminary Release

CONTENTS

1. Introduction	1
2. Applications	1
3. Package Contents	1
4. System Requirements	1
5. Features	1
6. Operation Controls and Functions	2
6.1 Front Panel	2
6.2 Rear Panel.....	3
7. Connection Diagram	4
8. Specifications	5
8.1 Audio Specifications	5
8.2 Input Audio to Output Audio Chart	5



1. INTRODUCTION

The L/R and Optical Audio to HDMI Bridge is designed for analog or digital audio signal to be send out through HDMI. Allowing immidiate plug-and-play enjoyment over HDMI audio without obstruct. When connecting to a HDMI display a blue screen will appear with a simple OSD to show the current input audio. Supporting digital audio sampling rate up to 192kHz and analog audio sampling rate up to 48kHz.

2. APPLICATIONS

- L/R or Optical audio convert to HDMI output
- HDCP regulated HDMI devices
- Audio management and control system

3. PACKAGE CONTENTS

- 1 x L/R & Optical Audio to HDMI Bridge
- 1 x 5V DC Power Adaptor
- Operational Manual

4. SYSTEM REQUIREMENTS

Input audio source equipment with L/R or Optical ouptut and HDMI devices such as TV/ Display or HDMI equipments.

5. FEATURES

- Supports Analog to Digital audio Conversion (ADC)
- Supports Optical audio sampling rate 32kHz to 192kHz and LPCM 2CH
- Supports L/R audio smapling rate at 48kHz
- Plug and play with no software require

6. OPERATION CONTROLS AND FUNCTIONS

6.1 Front Panel

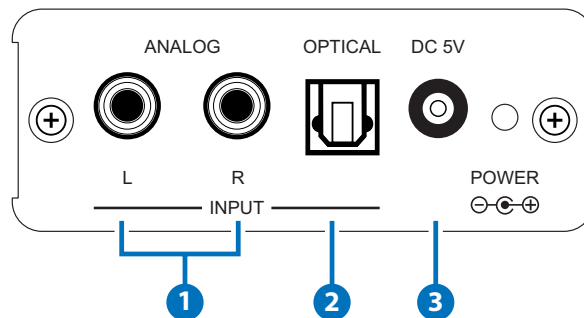

❶ INPUT L/R:

Connect from audio source equipment with L/R output with L/R RCA jack cables.

❷ INPUT Optical:

Connect from audio source equipment with optical output with optical cable.

❸ DC 5V & Power LED:

Plug the 5V DC power supply into the unit and connect the adaptor to an AC outlet the LED will illuminate when the device is connected with power supply.

6.2 Rear Panel

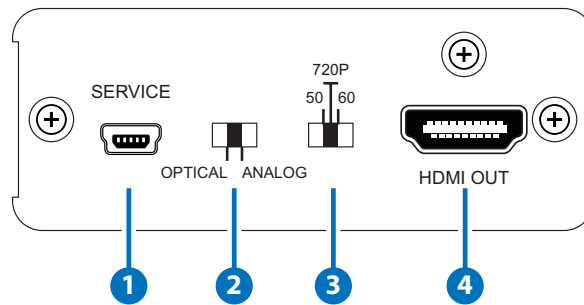

1 SERVICE:

This slot is reserved for factory firmware update only.

2 OPTICAL/ANALOG Switch:

Switch to select input from Optical or Analog L/R.

3 720p 50/60 Switch:

Switch to display output blue image with 720p/50 or 720p/60.

OSD will display current input audio and output timing for 15 seconds.

4 HDMI OUT:

Connect with HDMI equipped device such as HDMI matrix, switcher or HD TV/display.

Audio support up to 192kHz with Optical or 48kHz with Analog.

7. CONNECTION DIAGRAM

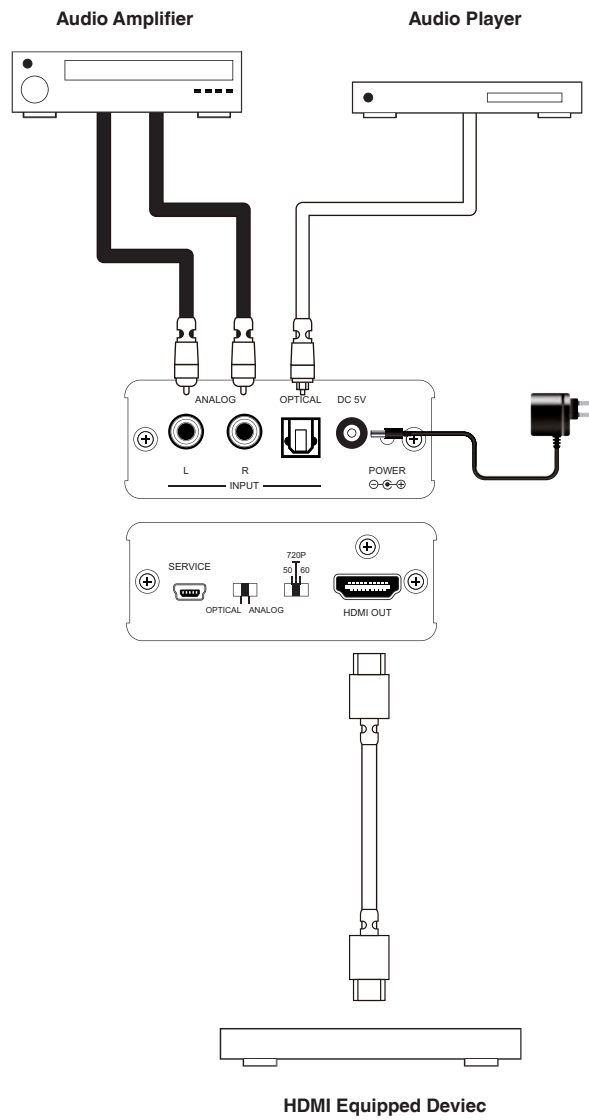

8. SPECIFICATIONS

Input port	1 x L/R (Analog Stereo 2RCA), 1 x Optical
Output port	1 x HDMI
Audio Input Sampling Rate	L/R: 48kHz Optical: 32~ 192kHz, LPCM 2CH
ESD Protection	Human body model: ±8kV (air-gap discharge) ±4kV (contact discharge)
Power Supply	5V/ 2.6A DC (US/EU standards, CE/FCC/UL certified)
Dimensions	78.5mm(W) x 95.5mm(D) x 30mm(H)
Weight	170g
Silkscreen Color	Black
Operating Temperature	0°C ~ 40°C / 32 °F ~ 104 °F
Storage Temperature	-20°C ~ 60°C / -4 °F ~ 140 °F
Relative Humidity	20 ~ 90% RH (non-condensing)
Power Consumption	2.6W

8.1 Audio Specifications

INPUT	OUTPUT	Output Level	T.H.D+N	Frequency Response	SNR	Crosstalk
Optical 0dBFS 1kHz/ 32KHz~ 192KHz	HDMI	2Vrms ±10	<0.01%	±1 dBFS	>80 dB	<-80dB
Line 2Vrms/ 1KHz	HDMI	2Vrms ±10	<0.01%	±1 dBFS	>80 dB	<-80dB

8.2 Input Audio to Output Audio Chart

Audio Input	Input Format	HDMI Audio Output
Analog L/R	Analog 2CH	LPCM 2CH
OPTICAL	LPCM 2CH	LPCM 2CH
	Dolby Digital	Bypass



www.egerate.com

www.geratech.eu