

Jacob`s Chucks GC-5, GC-15, GC-15-10

Ideal for measuring tensile strength of
wires, shafts or rods



Feature

- The Jacob`s chuck has characteristic of better initial gripping and less slipping of test material on testing process.
- The secure chucking of test material is achieved by the attached tightening handle.

Application

- The Jacob`s chuck is installed on the force gauge for pull or compression test of shafts and rods



Note

- The Jacob`s chuck can not grip particular material or shape.
- Combining with a test stand, more stable measuring becomes possible.
- All information is subject to change without prior notice.

Specifications

	GC-5	GC-15	GC-15-10
Clamping stroke	Ø 0.5 to 6.5 mm		Ø 2.0 to 13 mm
Capacity	500 N (50 kgf)		1000 N (100 kgf)
Mounting screw	M6		M10
Weight	approx. 235 g		approx. 500 g
Attachment	tightening handle		
The recommended force gauge	PS/FB/DS2/ZTS/ZTA series	PS/FB/DS2/ZTS/ZTA series	PSH//ZTS/ZTA series

Dimensional drawing

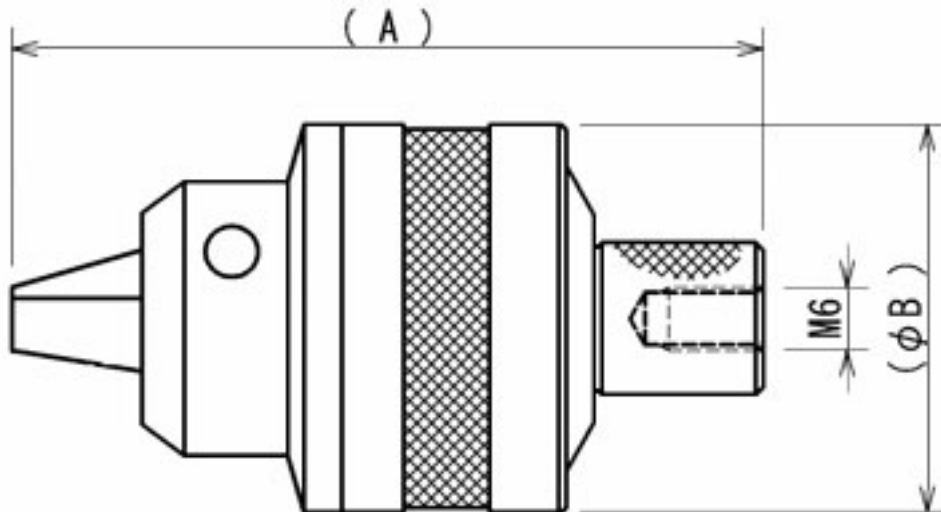

Model	(A) mm	(diameter B) mm	Screw hole
GC-5	72	37	M6
GC-15	101	45	
GC-15-10	101	45	M10