

Load Cell Model LMU and eLMU

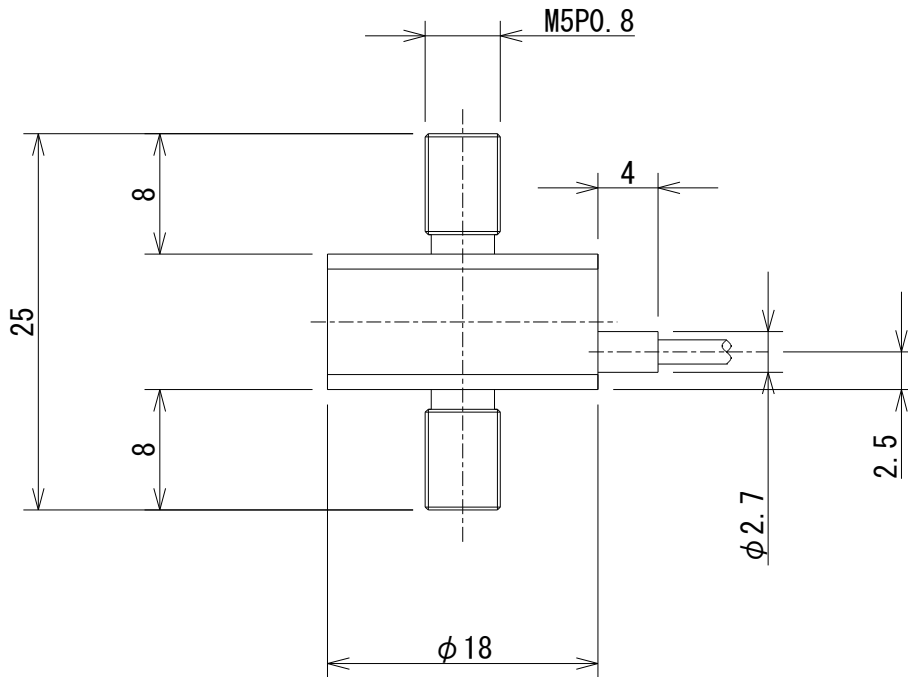

Model with Amplifier ZTS/ZTA*	Model with Amplifier eZT**	Measuring Range	Measuring Shaft
LMU-50N	eLMU-50N	5 N	M5 P0.8
LMU-100N	eLMU-100N	100 N	
LMU-200N	eLMU-200N	200 N	
LMU-500N	eLMU-500N	500 N	

* Accuracy ± 1.0 % full scale

** Accuracy ± 1.2 % full scale