



One (1) Fiber Detachable DVI Module, DVFX-100-TR

Description

OPTICIS 1-fiber Detachable DVI Extender, DVFX-100 is easy to connect to your existing system, giving you and your customers the confidence that you have the best solution in the market.

With powerful OPTICIS fiber-optic technology, DVFX-100 is capable of driving uncompressed 2K resolution at 60Hz DVI signal up to 500 meters (1,640feet) over one(1) multi-mode fiber (OM2 or OM3), and 300m (984ft) with OM1 fiber. .

For better installation flexibility, it features Self-EDID management, reading and restoring by just plugging to the display. It is also certified UL/EN 60601-1 for medical uses and FCC/CE and Class 1 LASER Industry Safety for various applications.

The Opticis 1-fiber detachable DVI extenders, DVFX-100, is sure to advance the connectivity solution with its high quality in video transmission and cost effectiveness through using less fiber.

Specification

- Supports up to 2K resolution, 60Hz or 1080p, 36bit
- Supports bit rate up to 2.25Gbps.
- Transmits signal up to 500m over Multi-mode fiber (OM2 or OM3), and 300m (984ft) with OM1 fiber.
- Offers Self-EDID function.
- Provides wide operating temperature range, 0-50 degree.
- Terminated by SC connector.
- Provides Power, Status (Signal transmission in TX and Signal detection in RX) LED Indicators.
- Small enough to be plugged to DVI sources and displays directly
- Certifications: UL/EN 60601-1, 60601-2, FCC/CE, Class 1 LASER Eye Safety.

Applications

- Medical imaging system
- Video wall system
- Digital signage
- Military / Aerospace
- Broadcast

One (1) Fiber Detachable DVI Module, DVFX-100

Technical Features

Resolution	Up to 2K resolution, 60Hz or 1080p 36bit
Bit rate	Up to 2.25Gbps
Maximum distance	500m @WUXGA, 60Hz with OM2 or OM3 fiber 300m @WUXGA, 60Hz with OM1 fiber
Fiber	SC terminated 1 core multi-mode fiber
EDID management	Self EDID (Reading from display and storing it in TX)
Power supplying	TX: DVI source or External 5V DC power RX: External 5V DC Power
LED Indicators	TX: Power, Signal transmission RX: Power, Signal detection
Power consumption	TX: 1.2W RX: 1.0W
Size (WDH)	39 x 56 x 14.6mm
Operating temperature	0 ~ 50 °C

Dimension

39 x 56 x 14.6mm (WDH)

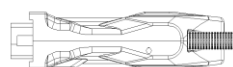
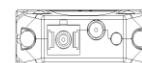
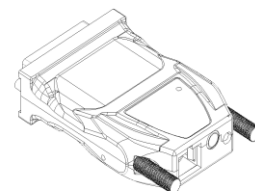
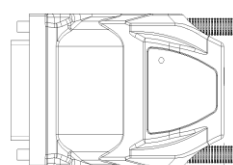

Connection Diagram

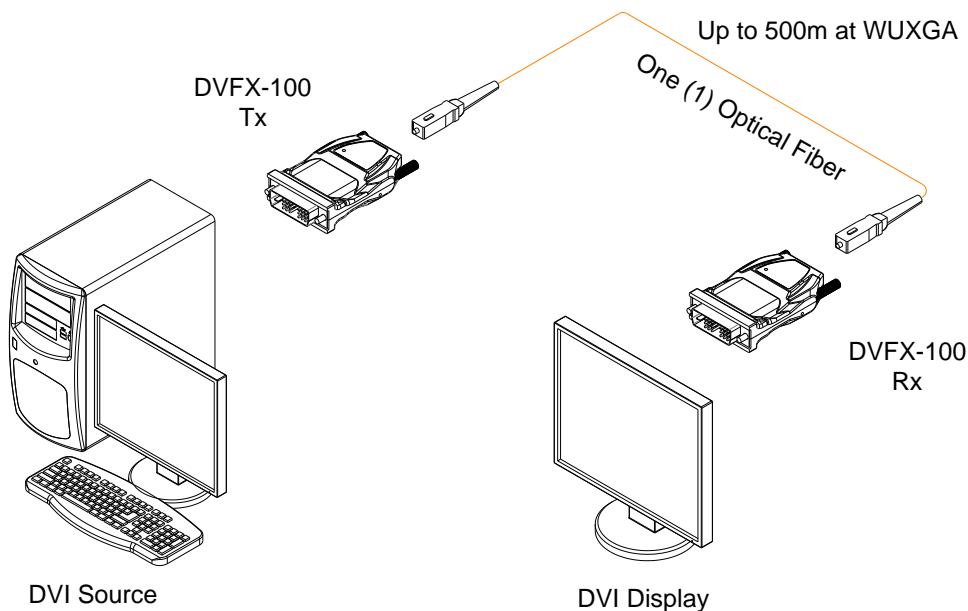

Opticis Co., Ltd.
 3F, 305, Sanseong-daero Sujeong-gu
 Seongnam-si, Gyeonggi-do, 13354 South Korea
 Tel: +82 (31) 719-8033
 Fax: +82 (31) 719-8032

tosales@opticis.com



All contents are subject to be changed without prior notice.