

1 Outline

SLH Manual Horizontal Spiral Test Stand is specially applied with SN, SKN, SH, SP series push-pull gauge. It is used in many trades and scientific research institution, as tension/compression load, insertion/withdraw, level peel-off and fracture test. It can be used on various working tables, manual operation, simple and stable.

Dimension: L542×W189×H271 mm;

Weight: 21.5 Kg;

Stroke: 250mm;

Capacity: 1000N;

Applied with (purchase additional): SN, SKN, SH, SP series push-pull gauge, various clamps/hooks.

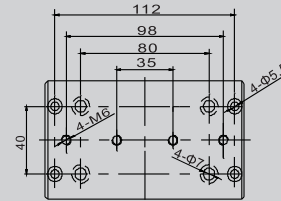

Picture 1 Top plate mounting dimension

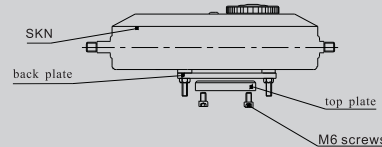

Picture 2 SKN installation

2 Structure

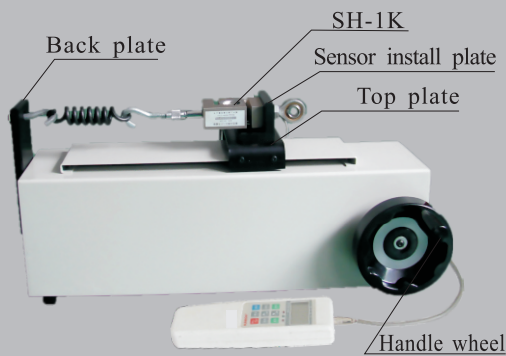

Notice: The SH-1K gauge should be purchased additionally

2. Analog force gauge installation (SN series): with M3 cross-screwdriver to discharge 4 M3×8 screws in the back cover of gauge (Picture 3), with accessories 4 M3×14 screws through the holes of 30×145 in the back of the plate into the mounting holes of gauge, tighten the screws, then mount the plate on the test stand (Picture 4);

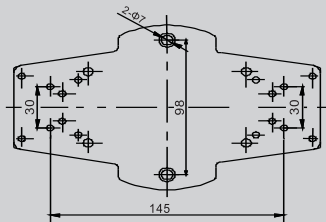

Picture 3 Plate installation dimension

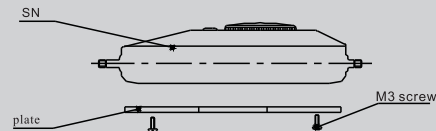

Picture 4 SN installation

3 Installation of push-pull gauge

1. Analog force gauge installation (SKN series): use M5 spanner to demount the top plate on the test stand (Picture 1); with accessories 4 M6 screws to be through the back of the top plate by the holes in it, install the back plate into the top plate and mount the top plate on the test stand (Picture 2);

3. Installation of digital push-pull gauge (inside): with accessories 4 M3 screws through the holes of 30×145 (Picture 3) in the back of the plate into the mounting holes of gauge, tighten the screws, then mount the plate on the test stand (Picture 5);

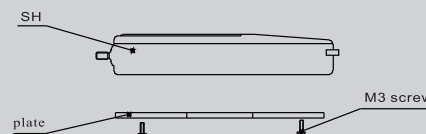

Pictuer 5 SH(inside)installation

- 4.Installation of digital push-pull gauge(S type sensor): with accessories 2 M6 screws,install the sensor directly onto the test stand,joint bearing of accessory, S type sensor fixed as (Picture 6)

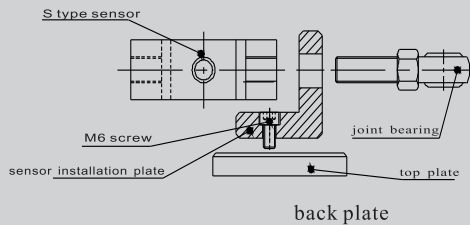

Picture 6 S type sensor installation

5.

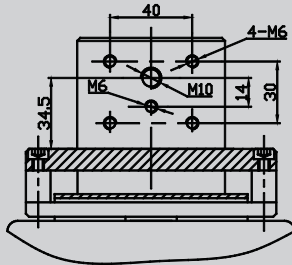

Picture 7 Mounting dimension of the plate

4

Attention

- 1.The capacity for this test stand is 1000N, not be over load; otherwise, there will be a breakdown and dangerous;
- 2.When carrying and using, take lightly and put lightly;
- 3.Do not use this test stand in the place that water, oil or other liquid maybe splash on it;
- 4.Please use soft cloth to clean it, put dry cloth into the water with detergent, wring then to clean dust and dirt. without volatile chemical, like volatile oil, thinner, alcohol and so on;
- 5.Do not disassemble、 repair or modify this test stand, it will caused permanent fault.

5

Packing list

Number	Name	Quantity
1	Test Stand	1
2	M5 Inner Spanner	1
3	M6 Inner Spanner	1
4	Plate	1
5	M6 Washer	2
6	M6×16 Screw	4+1
7	Manual	1
8	Qualification Certificate	1

MANUFACTURER:WENZHOU SUNDOO INSTRUMENTS CO.,LTD

Add: Building E, No.10 High-tech Industrial zone, Wenzhou, China

Zip Code: 325013

Tel: +86 577 88609905

Fax:+86 577 88390155

Http://www.sundoo.com

E-mail:export@sundoo.com